

CERTIFIED COPY

NOT FOR CONSTRUCTION

NOT FOR CONSTRUCTION

NOT FOR CONSTRUCTION

NOT FOR CONSTRUCTION

NOT FOR CONSTRUCTION

NOT FOR CONSTRUCTION

NOT FOR CONSTRUCTION

NOT FOR CONSTRUCTION

NOT FOR CONSTRUCTION

NOT FOR CONSTRUCTION

NOT FOR CONSTRUCTION

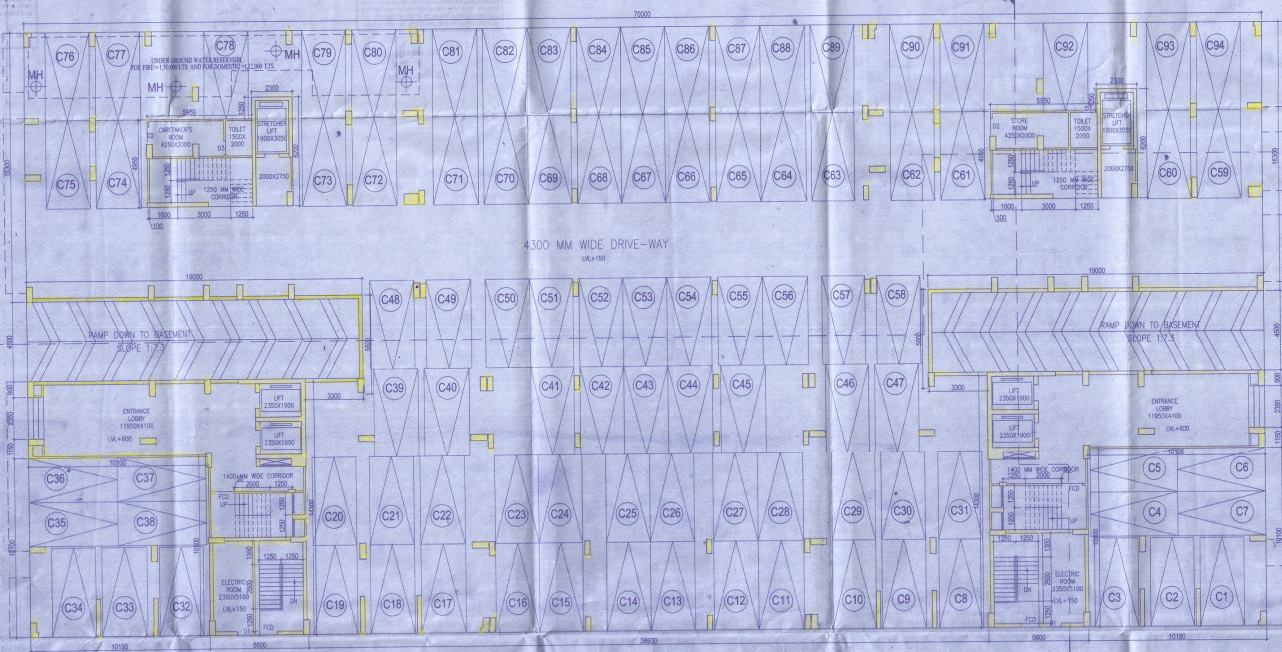

GROUND FLOOR PLAN

PROJECT:
 PROPOSED ADDITION OF ONE FLOOR US 804 (OF KMC ACT 1986) OVER AND ABOVE THE SANCTIONED HIGH-RISE RESIDENTIAL BUILDING AT PLOT NO. 203, B.L. SHAR ROAD, KOLKATA - 700093, R.S. PLOT NOS- 447, 832/101, 833/841, 833/838, 831/104, 817, 818, 848 & 816, R.S. KHATAN NO. 382, 574, 711, 199, 201 & 1112 OF MOUDA, ITALGHATA, LKNOB-103/8, BELLA, WARD NO. 116, BORCHOUR NO. 201 IN MODIFICATION FROM BP NO. - 20173058 DATE- 07/11/2017

TITLE: GROUND FLOOR PLAN

SCHEDULE OF DOORS					SCHEDULE OF WINDOWS					
TYPE	WIDTH	HEIGHT	REMARKS	TYPE	SIZE	LOUVER	REMARKS	TYPE	SIZE	REMARKS
SD	900	2100	SLIDING DOOR	W1	900X1800		DOB			
DD	900	2100		W2	900X1800		DOB			
LD	900	2100		W3	900X1800		DOB			
SD	1500	2100		W4	900X1800		DOB			
FD2	1800	2100		W5	900X1800		DOB			
FD3	900	2100		W6	900X1800		DOB			
				W7	900X1800		DOB			

CERTIFICATE OF GEO-TECHNICAL ENGINEER:
 I, THE UNDERSIGNED HAS INSPECTED THE SITE AND GROUND OUT OF THE EAST TO WEST AND FOUND THAT THE EXISTING SOIL OF THE SITE IS OF CATEGORY 'B' AND THE PROPOSED CONSTRUCTION AND THE FOUNDATION SYSTEM PROPOSED DESIGN IS SAFE & STABLE IN ALL RESPECTS FROM GEO-TECHNICAL POINT OF VIEW.

[Signature]
 S. K. GHOSH
 CIVIL ENGINEER
 REG. NO. 12718
 MEMBER OF STRUCTURAL SUBMITTEE

DECLARATION OF STRUCTURAL ENGINEER
 THE STRUCTURAL DESIGN OF BOTH FOUNDATION AND SUPERSTRUCTURE OF THE BUILDING HAVE BEEN MADE BY ME CONSIDERING ALL POSSIBLE LOADS INCLUDING THE SEISMIC LOADS PER IS 800 AND BASED ON SOIL INVESTIGATION REPORT BY GEOLOGICAL, GEOTECHNICAL, CONSULTANTS & CIVIL ENGINEERS OR PRACTISING ARCHITECT OR MECHANICAL ENGINEER, BELLA, KOLKATA, WHOSE DESIGN IS SAFE & STABLE IN ALL RESPECTS.

[Signature]
 S. K. GHOSH
 CIVIL ENGINEER
 REG. NO. 12718
 MEMBER OF STRUCTURAL SUBMITTEE

DECLARATION OF ARCHITECT
 I CERTIFY THAT THE PLAN IS PREPARED WITH FULL RESPONSIBILITY THAT THE BUILDING PLAN WAS DRAWN UP AS PER PROVISION OF K.M.C. BUILDING RULES 2006 AND AMENDMENTS THERE TO AND AS PER THE SITE CONDITION INCLUDING THE NEIGHBOURHOOD CONCERN WITH THE PLAN. IT IS BELIEVED THAT NO TANK OR FILLED UP TANK THERE IS AN EXISTING TO BE DEMOLISHED BEFORE COMMENCEMENT OF WORK OR IF IT IS FULLY OCCUPIED BY THE OWNER, THERE IS NO TANK.

[Signature]
 DEBARTOSH SAHAI
 ARCHITECT & ARCHITECTURE
 14/1, BELLA, KOLKATA
 REG. NO. 12718
 MEMBER OF ARCHITECT

DECLARATION OF OWNER
 I, THE UNDERSIGNED DECLARE WITH FULL RESPONSIBILITY THAT I SHALL ENGAGE A E & E USE DURING CONSTRUCTION FINANCED ON THE INSTRUCTION OF L.M.A. & DURING CONSTRUCTION OF THE BUILDING AS PER PLAN. THE AUTHORITY WILL NOT BE RESPONSIBLE FOR STRUCTURAL STABILITY OF THE BUILDING ACCORDING STRUCTURE OR ANY SUBMITTED DOCUMENT AND PLAN. THE K.M.C. AUTHORITY WILL REVIEW THE SANCTION PLAN THE CONSTRUCTION OF URBAN SEPTIC TANK TAKEN UNDER THE GUIDANCE OF LESSEE BEFORE STARTING OF BUILDING FOUNDATION.

[Signature]
 S. K. GHOSH
 CIVIL ENGINEER
 REG. NO. 12718
 MEMBER OF ARCHITECT

ESPACE
 80A, DR. BAKSI ENCLAVE ROAD, KOLKATA-700078
 TEL: 033-25551111
 WWW.ESPACEGROUP.COM

THIS DRAWING IS A PROPERTY OF ESPLACE AND BY NO MEANS SHALL THIS BE COPIED, LENT OUT IN WHOLE OR PART, WITHOUT PRIOR PERMISSION FROM THE CONSULTANTS.

APPROVED BY M.B.C. *[Signature]*
 ASSISTANT ENGINEER (C)

APPROVED *[Signature]*
 CIVIL ASSISTANT ENGINEER (C)

THE SANCTION IS VALID UP TO 31/03/2018